

Fig. 1.20 Manual initial take-up type chain tensioner (Sec 18)

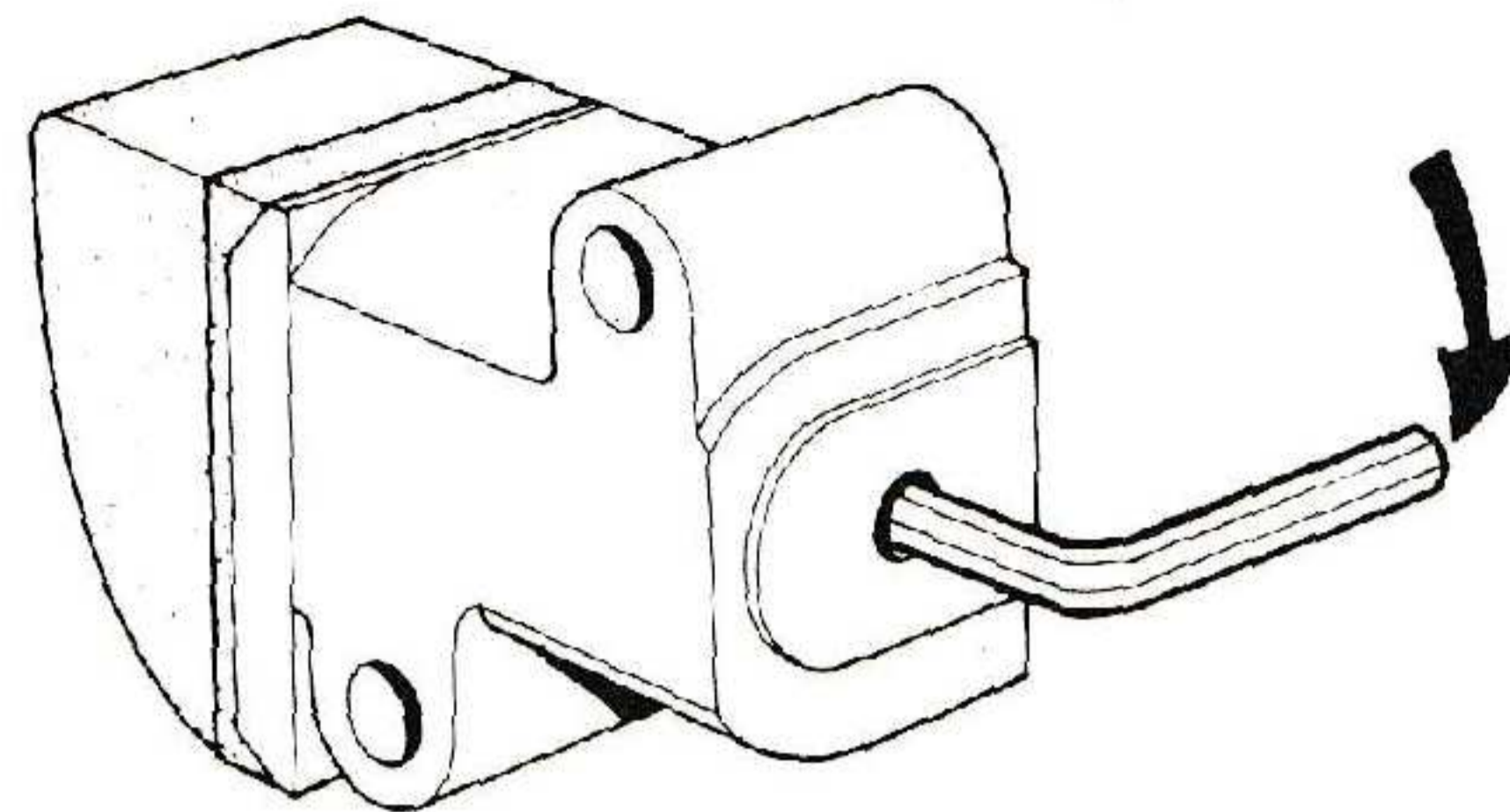

Fig. 1.21 Allen key for locking/unlocking chain tensioner (Sec 18)

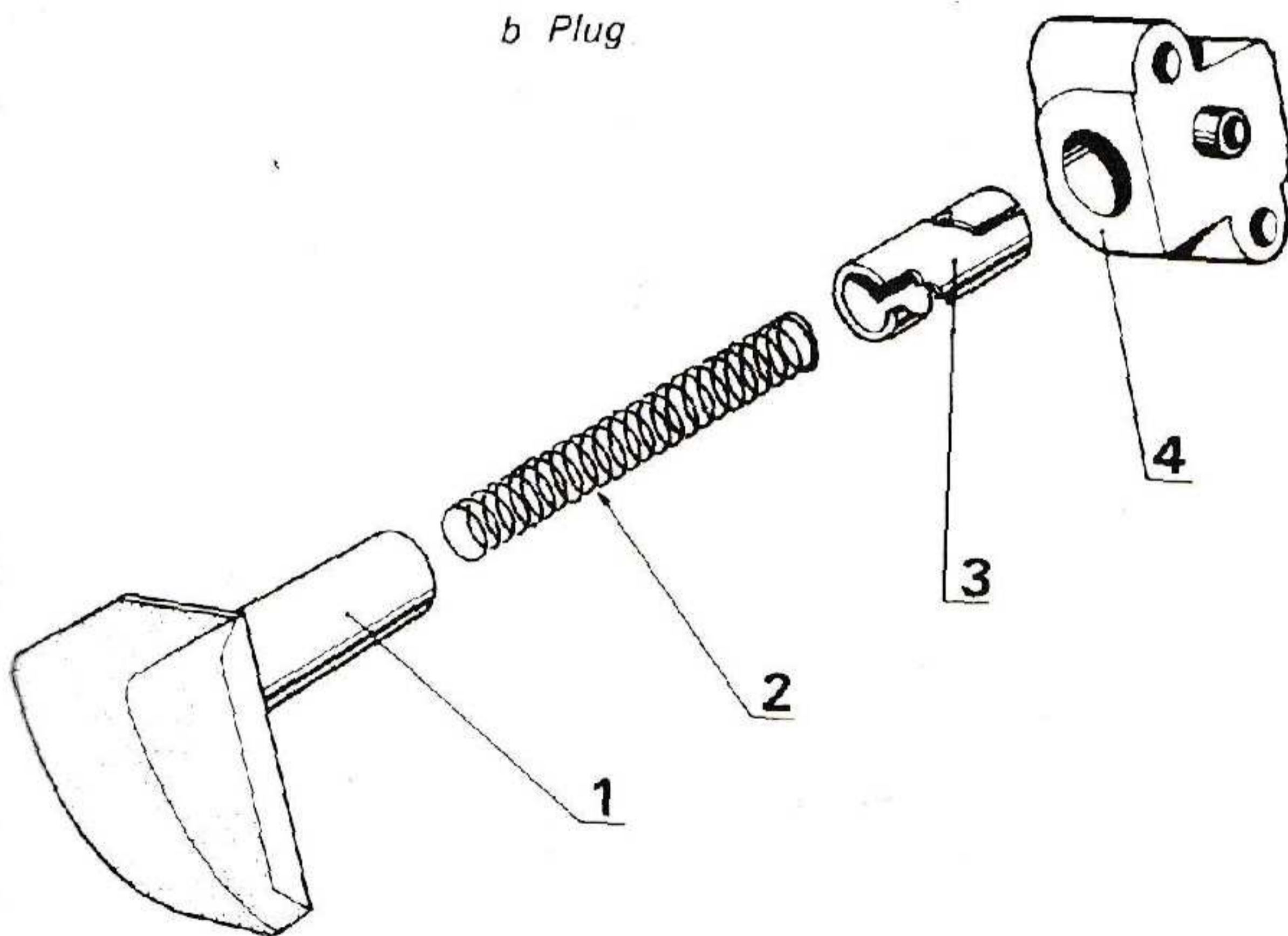

Fig. 1.22 Components of the automatic initial take-up type chain tensioner (Sec 18)

1 Slipper
2 Spring

3 Piston
4 Tensioner body

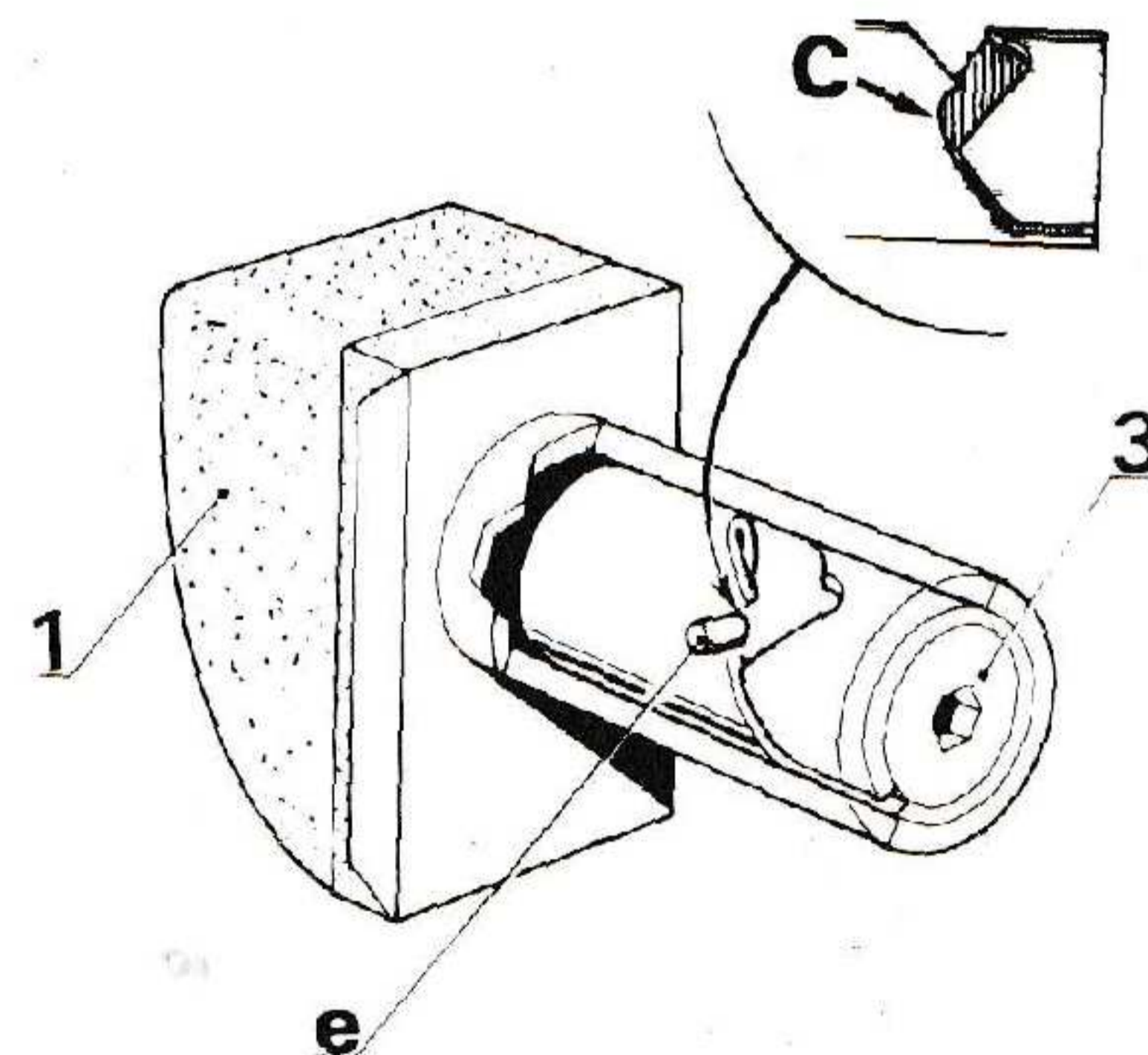

Fig. 1.23 Automatic chain tensioner assembled (Sec 18)

1 Slipper
3 Piston

c Notch
e Peg